

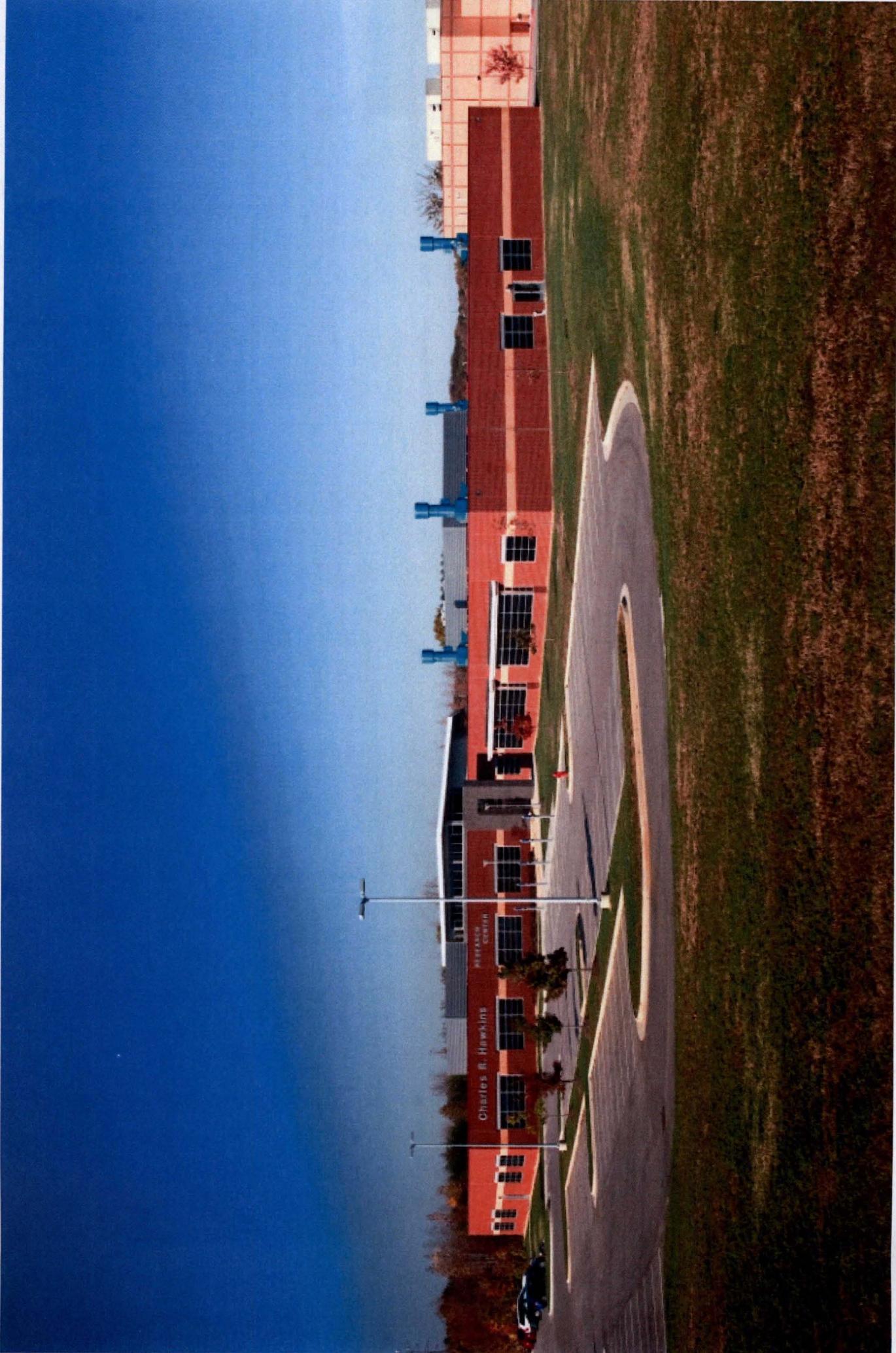

The INSTITUTE  
FOR  
ADVANCED LEARNING & RESEARCH





Charles B. Hawkins  
PITACUS CENTER





Site Layout



## **CANE CREEK CENTRE**

The Cane Creek Centre is a nine hundred twenty-eight (928) acre manufacturing industrial park being developed jointly by Pittsylvania County and the City of Danville through the Regional Industrial Facilities Authority. This park is located between U.S. Route 58 and U.S. Route 29 North. It is designed to accommodate industries that require large land areas and are major utility users. Interested industries began requesting locations in the park before the County and the City could even get the industrial access road under contract. Currently, the industrial park houses a one million (1,000,000) square foot, furniture manufacturing facility, Swedwood North America (a division of IKEA) and a three hundred thousand (300,000) square foot facility for Yorktowne Cabinetry products. Out of the original nine hundred twenty-eight (928) acre proposed site, there is currently available only three hundred fifty-three point seven (353.7) acres of land for additional industries and development. This has caused the Regional Industrial Facility Authority to move on to build the new three thousand, five hundred (3,500) acre mega park.





Swedwood  
Yorktowne



Cane Creek  
Centre



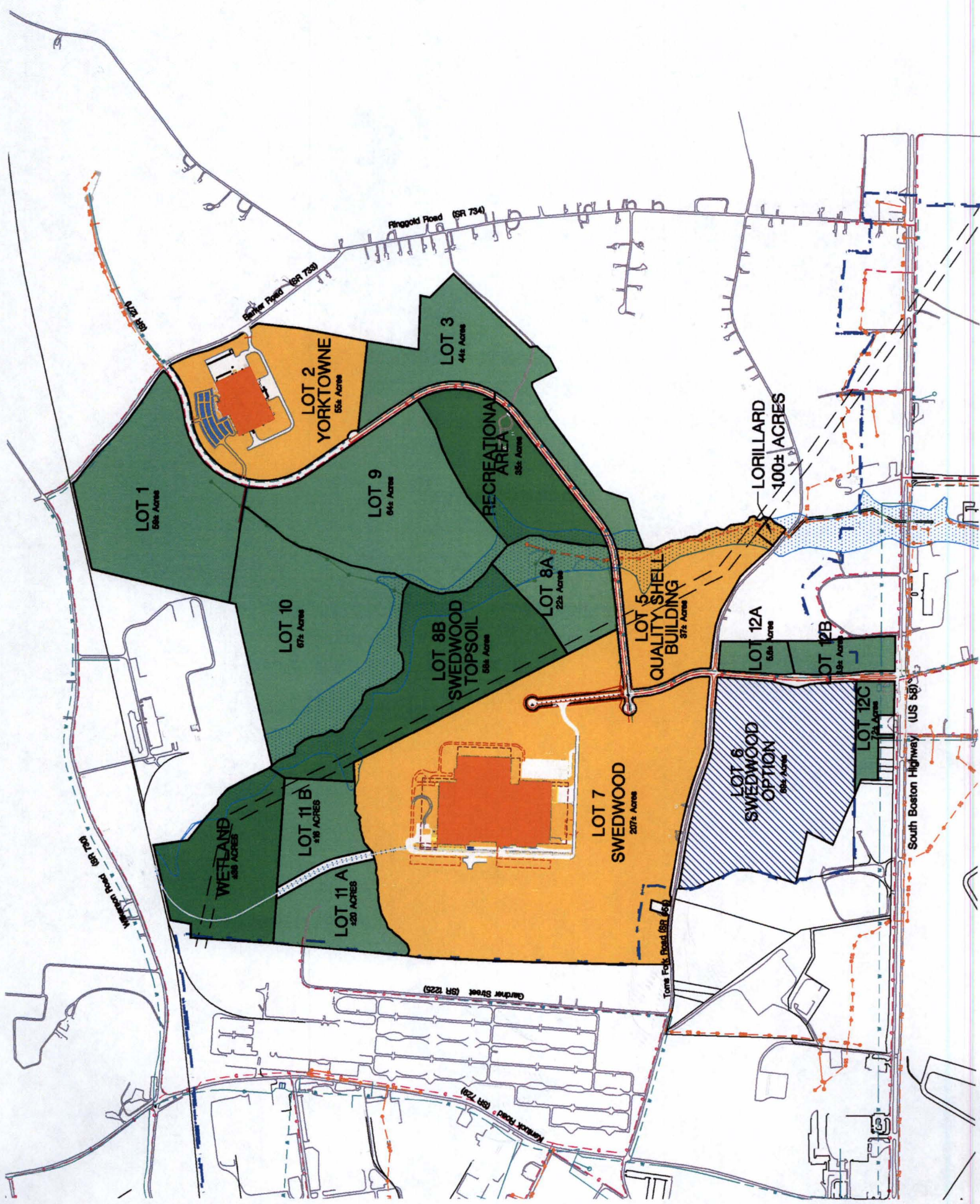







## **MEGA PARK**

Following the success of the Cane Creek Centre, the Danville-Pittsylvania Regional Industrial Facility Authority set out to develop a Mega Park in the southern part of the County in order to meet the requirements of the Commonwealth of Virginia in the new direction of the Governor and the Virginia Economic Development Partnership. The Danville-Pittsylvania Regional Industrial Facility Authority, with the cooperative effort and support of the County of Pittsylvania and the City of Danville, has purchased three thousand, seven hundred (3,700) acres between the City of Danville and the City of Eden, North Carolina on Berry Hill Road in Pittsylvania County.

The Regional Industrial Facility Authority hired a consultant firm of McCullum Sweeny to certify the Mega Park as one of the National Certified Mega Parks. The County of Pittsylvania is developing the required water and sewer services to the park through a cooperative agreement with the City of Eden, North Carolina who will provide the necessary water to this industrial park. The City of Danville partnering with the County of Pittsylvania will be providing the gas and the necessary electric power to service this park. In addition, the development of this park requires upgrading five (5) miles of a railroad, a new four line industrial access road off of the U.S. Route 58 Bypass, as well as significant requirements in the park for site development and pad development for proposed industries.

Because of the success of the Danville-Pittsylvania Regional Industrial Facility Authority, we are already having pressure from businesses and industries to try to locate in the Mega Park before the park is even designed or built. This shows the representation and the success of the Danville-Pittsylvania Regional Industrial Facility Authority and the respect of its surrounding jurisdictions willing to work with and hoping that this park will provide the significant job anchor that southern Virginia and northern part of North Carolina need to recover from the losses of furniture, textiles, apparel and tobacco from our communities.







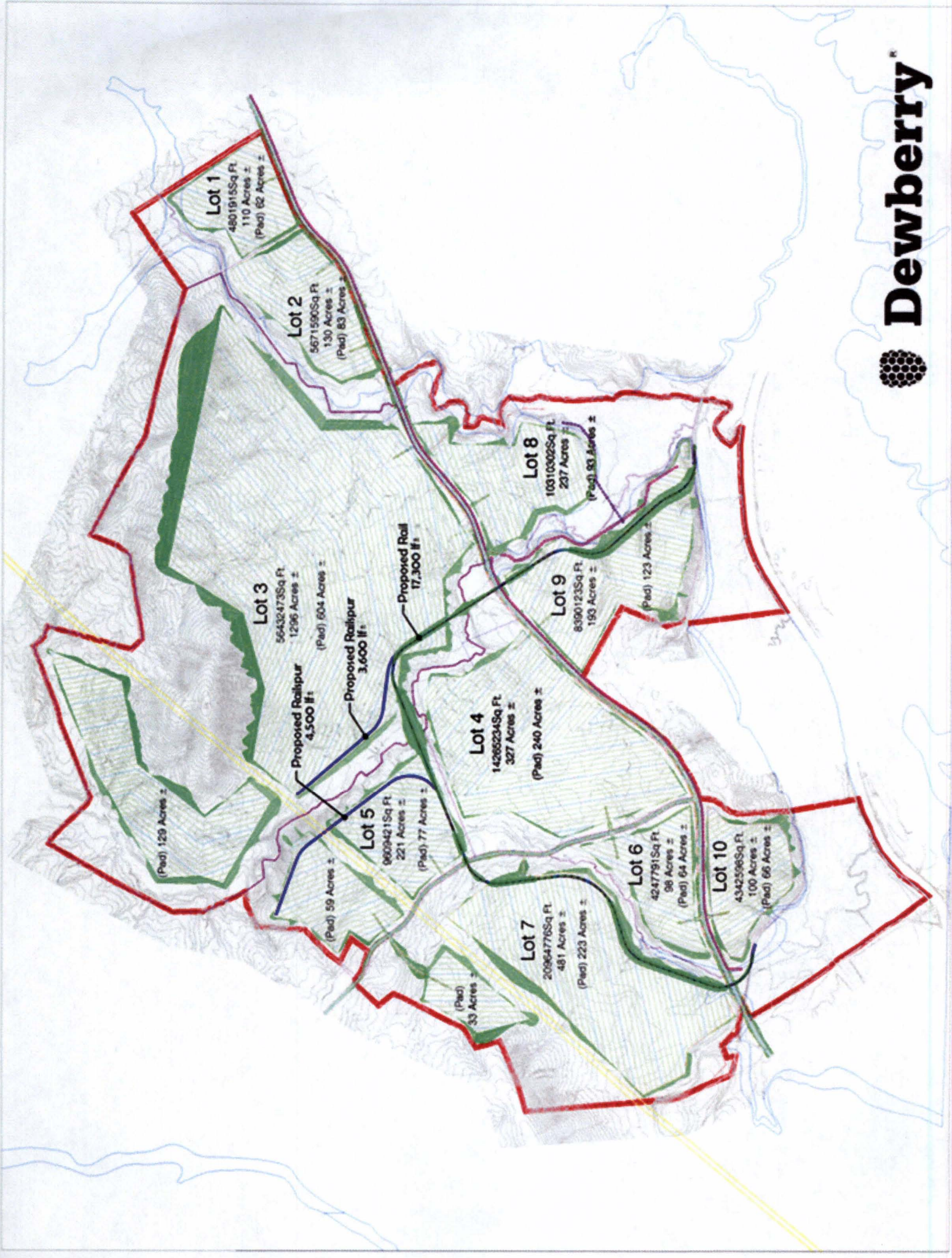

**Dewberry**